



# LHseries LH12II

## Two-way Loudspeaker System

### FEATURES

- High quality unit configuration, high strength plywood housing
- Small size, light weight, easy handling and fixed installation
- Multi-hanging points and support, easy and quick operation
- Applications: large-scale indoor sound reinforcement, multifunction halls, high-end hotel clubs, touring, band reinforcement and monitor speaker

The LH12 II is a 12", light weight, high SPL, two way full range speaker with clear and bright sound. Unit configuration: 1x12" high efficiency neodymium mid-bass unit, 1x1" exit throat 44mm neodymium polyimide diaphragm HF driver with 90°×40° rotatable horn. The cabinet is made of multilayer composite plywood with wear-resistant polyurea paint.

### CONFIGURATION

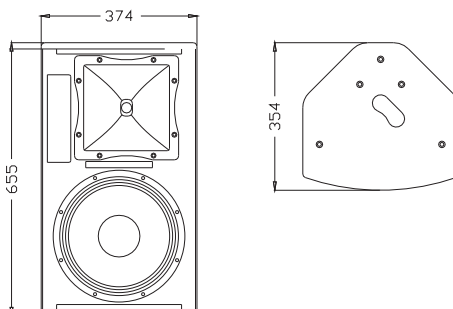

#### MODEL

FREQUENCY RESPONSE(-3dB)

FREQUENCY RESPONSE(-10dB)

#### DRIVERS

#### RATED POWER

#### SENSITIVITY

#### MAXIMUM SPL

#### IMPEDANCE

#### DISPERSION(-6dB)

#### CROSSOVER FREQUENCIES

#### INPUT CONNECTORS

#### PACKAGE SIZE

#### NET WEIGHT

#### GROSS WEIGHT

#### LH12 II

55 Hz-18kHz

50 Hz-20kHz

1 × 12"(300mm)/3"voice coil LF

1 × 1"(25mm)/1.7"voice coil HF

300W RMS,1200W peak

97dB 1watt/1 metre

122dB continuous,128 dB peak

8 ohms nominal

90°×40°

2.5kHz passive

2 × Speakon NL4

470mm × 450mm × 755mm

17 kg/pc

19 kg/pc

